

CHRISTIE CLUB I & II CONDOMINIUMS

AREA	Mountain-North Side
ADDRESS	2355 Ski Time Square Drive
MGMT. COMPANY	Steamboat Resorts
MGMT. CO. CONTACT	Adam Reichley
MGMT. CO. PHONE	970-879-7900
WEBSITE	www.christieclubsteamboat.com
YEAR BUILT	Bldg. I 1997; Bldg. II 2002
ON-SITE CHECK-IN	Yes
SKI-IN/SKI-OUT	Yes
PETS	Owners Only
SHUTTLE	Yes, Seasonal
RENTALS	Nightly
RIGHT OF FIRST REFUSAL	Yes
WORKING CAPITAL	Yes
GARAGE	Carport
ELEVATOR	No
MAIN LEVEL MASTER	Yes-Some floor plans



UNIT TYPE	# OF UNITS	SQUARE FEET
2 Bed/2 Bath	1	1616 sf
3 Bed/3 Bath	19	1900+/- sf
4 Bed/4 Bath	14	2200+/- sf

HOA AMENITIES

- Outdoor Pool
- Outdoor Hot Tub
- Sauna
- Athletic Facilities
- Recreation Facilities
- Club House
- Game Room
- Shuttle

HOA FEE INCLUDES

- Electric
- Gas
- Water
- Sewer
- Cable TV
- Trash Service
- Lawn Maintenance
- Insurance
- Building Maintenance
- Shuttle Service
- Snow Plowing
- Snow Shoveling
- Common Amenities

UNIT/PROPERTY AMENITIES

- Outdoor Pool
- Outdoor Hot Tub
- Sauna
- Athletic Facilities
- Recreation Facilities
- Club House
- Storage
- Season Shuttle
- Valet
- Concierge
- On-site Check In
- Covered Parking
- HOA Shuttle
- Washer & Dryer in Unit
- Fully Equipped Kitchen
- Boot/Glove Dryers for Members
- Game room

Steamboat

Sotheby's
INTERNATIONAL REALTY

steamboatsir.com | Main 970.879.8100 | Mountain 970.879.7800 | Downtown 970.870.8885

This information is believed to be accurate but is not guaranteed, and is subject to change.

CHRISTIE CLUB I & II CONDOMINIUMS

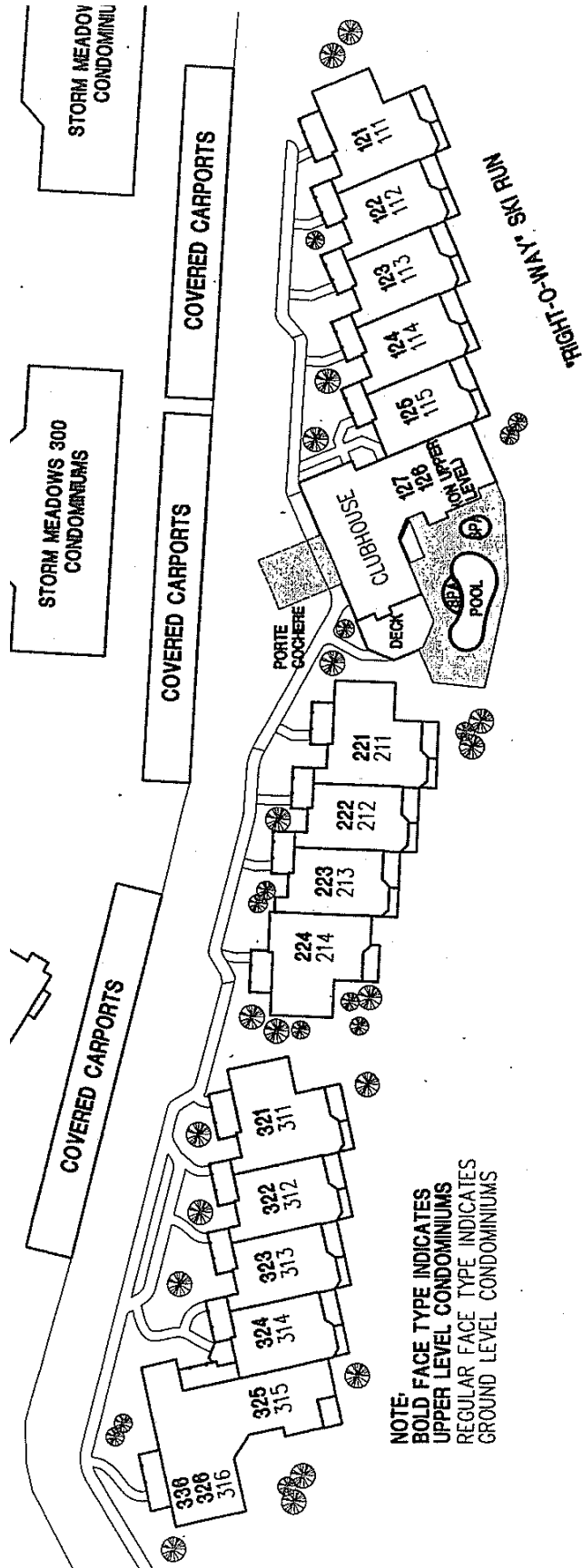

NOTE:
**BOLD FACE TYPE INDICATES
 UPPER LEVEL CONDOMINIUMS**
 REGULAR FACE TYPE INDICATES
 GROUND LEVEL CONDOMINIUMS